



VOZROZHDENIE LLC

OKPD 2 26.30.50.110

TU 26.30.50-007-33120038-2017

APPROVED BY

VZR.235900.000 LU

TURNSTILE CUBE C-04 MODEL

C-04-s, C-04-K, C-04-Ks, C-04-N, C-04-Ns, C-04-NK, C-04-NKs

VZR.235900.000 OM OPERATION MANUAL

44 sheets

2020

TABLE OF CONTENTS

| | | |
|----------|--|-----------|
| 1 | Description and operation | 4 |
| 1.1 | Product description and operation | 4 |
| 1.2 | Description and operation of Ovgard Praktika control panel | 9 |
| 1.3 | Description and operation of the card collector (optional) | 10 |
| 2 | Intended use..... | 12 |
| 2.1 | Operating limits | 12 |
| 2.2 | Preparing the product for use | 13 |
| 2.3 | Product operation | 17 |
| 2.4 | Emergency procedures | 25 |
| 3 | Maintenance | 27 |
| 3.1 | General instructions..... | 27 |
| 3.2 | Safety precautions..... | 27 |
| 3.3 | Product maintenance procedure..... | 28 |
| 3.4 | Visual inspection of the product..... | 29 |
| 3.5 | Partial disassembly of the product..... | 29 |
| 3.6 | Checking the product assemblies | 30 |
| 3.7 | Product assembly and health check | 30 |
| 4 | Routine repairs..... | 32 |
| 4.1 | Routine repairs of the product | 32 |
| 4.2 | Routine repairs of the product components | 32 |
| 4.3 | Malfunctions during warranty period | 33 |
| 5 | Storage | 34 |
| 6 | Transportation..... | 35 |
| 7 | Disposal..... | 36 |
| | APPENDIX A — Distributors and service centers | 37 |
| | Abbreviations..... | 43 |

This Operation Manual (OM) applies to Oxgard Cube C-04 turnstile and its modifications (hereinafter referred to as the product). Product firmware version:

FW v.d.4

The manufacturer reserves the right to change configuration, technical characteristics and appearance of the product without further notice

Before using the product, please read the Logbook VZR.235900.000 LB as well.

This OM is a document certifying the product's basic parameters and characteristics guaranteed by the manufacturer.

The Operation Manual is designed to instruct the user on the principle of operation, structure of the product to correctly operate the product, fully utilize its technical capabilities and maintain its constant readiness for operation.

1 DESCRIPTION AND OPERATION

1.1 Product description and operation

1.1.1 Oxgard Cube C-04 turnstile is designed to control access and manage people traffic separating it in one-by-one manner.

The product can be used at checkpoints of enterprises, organizations and banks, in educational institutions, sports and entertainment facilities, shops, railroad stations and other institutions. To ensure convenient and fast passage of people, it is recommended to install one product per 500 people working during one shift.

1.1.2 The product structure is provided in Table 1.

Table 1 – Product components

| Product designation | Product | Quantity | Note |
|----------------------|----------------------------------|----------|------|
| Turnstile | Cube C-04 | 1 | |
| Control panel (CP) | Praktika universal control panel | 1 | |
| Power supply source* | | 1 | |
| Reader for PC* | | 1 | |
| Card collector* | | 1 | |
| Barrier section set* | Praktika barrier | 1 | |



Note — Product components marked with (*) are optional.

1.1.3 Individual features of the product's modifications.

The turnstile housing can be made in two variants:

Variant No. 1: the side covers and central patch members are made of stainless steel, while the internal elements of the stands and the top cover are painted (color at the customer's choice).

Table 2 – Configuration of turnstile modifications.

Table 2 – Turnstile modifications (Variant No. 1)

| Modification | Features |
|-----------------------------------|---|
| C-04-Ks (card collector + reader) | <ul style="list-style-type: none"> 1) two readers are built into the housing with LED lighting; 2) built-in card collector for 200 guest cards; 3) the turnstile is equipped with a simple access system for card withdrawal; 4) the housing includes painted elements. |
| C-04-K (card collector) | <ul style="list-style-type: none"> 1) built-in card collector for 200 guest cards; 2) the turnstile is equipped with a simple access system for card withdrawal; 3) the housing includes painted elements. |
| C-04-S (reader) | <ul style="list-style-type: none"> 1) two readers are built into the housing with LED lighting; 2) the housing includes painted elements. |
| S-04 | <ul style="list-style-type: none"> 1) the housing includes painted elements; 2) no readers. |

Variant No. 2: all patch members of the turnstile are made of stainless steel.

Table 3 – Configuration of turnstile modifications.

Table 3 – Turnstile modifications (Variant No. 2)

| Modification | Features |
|------------------------------------|---|
| C-04-NKs (card collector + reader) | 1) two readers are built into the housing with LED lighting; 2) built-in card collector for 200 guest cards; 3) the turnstile is equipped with a simple access system for card withdrawal; 4) stainless steel housing. |
| C-04-NK (card collector) | 1) built-in card collector for 200 guest cards; 2) the turnstile is equipped with a simple access system for card withdrawal; 3) stainless steel housing. |
| C-04-Ns (reader) | 1) two readers are built into the housing with LED lighting; 2) stainless steel patch members. |
| C-04-N | 1) stainless steel housing; 2) no readers. |

Barrier arms of all product modifications are made of hairline stainless steel.

In product modifications with readers – magnetic card readers PROX-13 or PROX-125 are installed (to be specified when ordering the turnstile). The readers are installed on the left and right side of the turnstile, in the upper part of the racks.

1.1.4 The product specifications are given in Table 4

Table 4 – Product specifications

| Parameter | Value |
|---|--------------|
| Overall dimensions (HxWxL), mm: - in operating condition | 1000x950x735 |

| | |
|---|----------------------|
| - with folded arms | 1000x950x192 |
| Weight, kg | 50.0 |
| Temperature range, °C: - operation - transportation and storage | +1...+40 +1...+40 |
| Relative air humidity, %, max. | 80 |
| Width of formed passage, mm | 565-595 |
| Throughput, persons/min | 30 |
| Max. number of connected control panels, pcs. | 2 |
| Service life, years | 8 |
| Supply voltage (direct current), V: - rated - operating | 24.0 23.0...25.0 |
| Average current in standby mode*, A | 1.5 |
| Average current in passage mode*, A | 1.5 |
| Maximum current consumption*, A | 3.0 |



Note — * values of current are given for rated supply voltage

1.1.5 Product structure.

The product side covers and central patch members are made of stainless steel, while the internal elements of the stands and the top cover are painted (color at the customer's choice). Barrier arms of the product are made of hairline stainless steel. LED lighting of the housing.

The cross-board located under the removable cover in the upper part of the product housing is used for connection of the PSU, CP and ACS cables. A hole is provided in the bottom part of the product housing to input these cables.

Figure 1 – general view of the product.

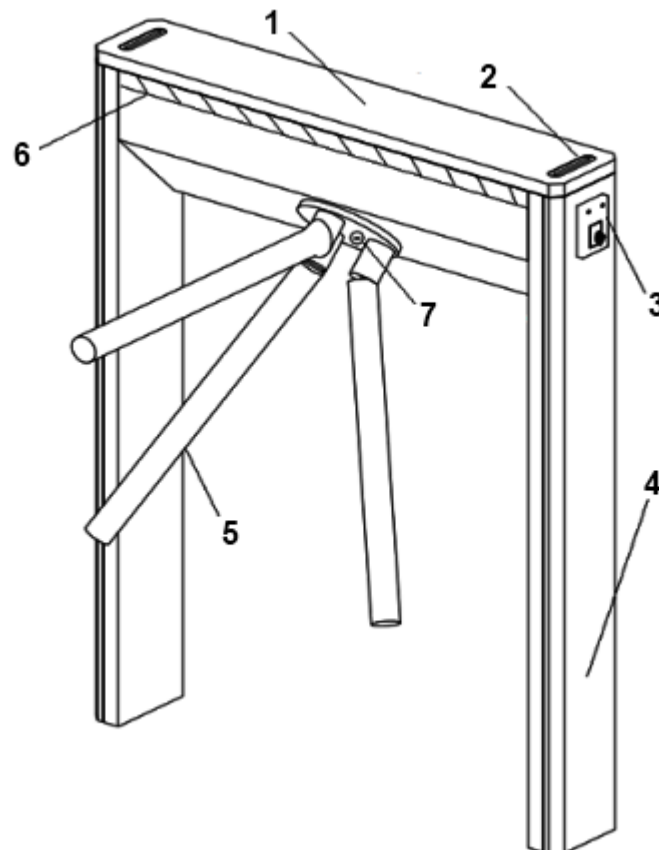

**1- top cover; 2 - card collector slot; 3 - reader;
4 - decorative side covers; 5 - barrier arms;
6 - front indication band; 7 - arm retainer**

Figure 1 – General view of the turnstile

1.1.6 Indication system.

The indication band is located in the turnstile upper part behind a Caprolon insert.

Figure 2 – turnstile operating modes are displayed on the front indication band (1) and are duplicated by side indication bands (2).

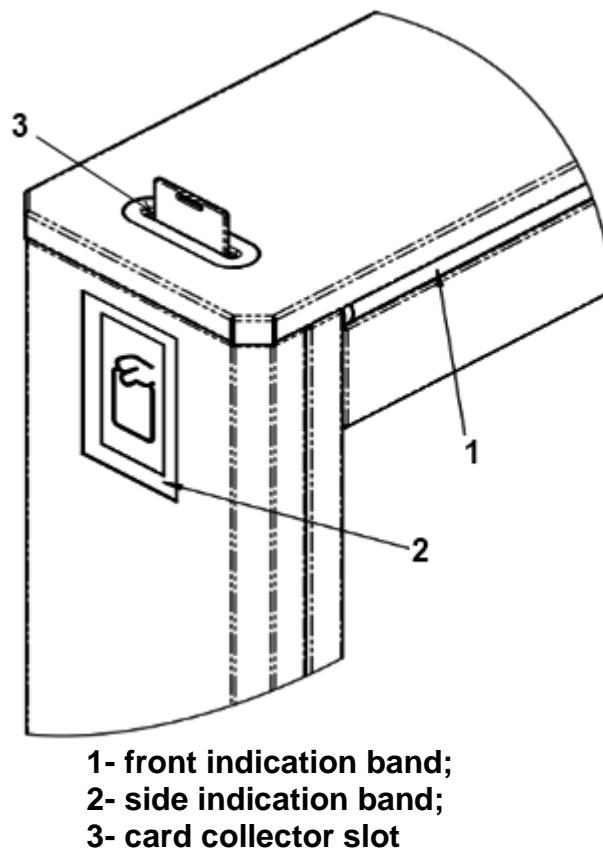

Figure 2 – Indication system appearance

1.1.7 Marking contains manufacturer's trademark, designation, and serial number.

1.1.8 Overall dimensions of the packaging container are:

- 1) Height 1170 mm;
- 2) Width 500 mm;
- 3) Length 1040 mm.

1.2 Description and operation of Oxgard Praktika control panel

Universal Oxgard Praktika control panel is designed for controlling Oxgard turnstiles.

1.2.1 Housing is made of stainless steel, control buttons and LEDs of operating mode indicators are located on the front side. Specifications are given in Table 5.

Table 5 – Product specifications

| Parameter | Value |
|---|----------------------|
| Overall dimensions (HxWxL), mm | 25x107x107 |
| Weight, kg | 0.5 |
| Temperature range, °C: - operation - transportation and storage | +1...+40 +1...+40 |
| Relative air humidity, %, max. | 80 |
| Service life, years | 8 |
| Supply voltage (direct current), V: - rated - operating | 12.0 11.0..13.0 |

1.2.2 Design features:

- 1) Possibility to connect two control panels to one turnstile;
- 2) High noise immunity;
- 3) Length of the wire from control panel to the turnstile can reach up to several kilometers without losing the speed of command transmission;
- 4) Standard length of the cable included in the package is 5 meters.

1.3 Description and operation of the card collector (optional)

1.3.1 Purpose of the card collector

The card collector is designed to collect and store contactless access cards at the facility exit. The flexible logic of operation and connection of the card

collector controller allows integrating the collector into any access control systems.

1.3.2 Description of structural elements. Figure 2 – card collector slot.

On the inside of the card collector racks there are two containers with locks for quick access to the withdrawn cards.

The containers are designed to hold at least 200 cards.



Note — The side of installing the card collector on the product is chosen by the customer, which is negotiated when concluding a supply contract

2 INTENDED USE

2.1 Operating limits



ATTENTION: FAILURE TO COMPLY WITH THE SAFETY REQUIREMENTS SPECIFIED IN THIS SECTION CAN RESULT IN DEATH AND DAMAGE TO HEALTH, COMPLETE OR PARTIAL LOSS OF PERFORMANCE OF THE PRODUCT AND/OR AUXILIARY EQUIPMENT.



ATTENTION: THE TURNSTILE SHOULD BE INSTALLED BY QUALIFIED SPECIALISTS ACCORDING TO THE INSTALLATION MANUAL.



ATTENTION: MANUFACTURER WAIVES ANY RESPONSIBILITY FOR DEATH AND DAMAGE TO HEALTH, COMPLETE OR PARTIAL LOSS OF PERFORMANCE OF THE PRODUCT AND/OR AUXILIARY EQUIPMENT IF USER FAILS TO COMPLY WITH THE SAFETY REQUIREMENTS SPECIFIED IN THIS SECTION, AND ALSO VOIDS THE PRODUCT WARRANTY.



DO NOT:

INSTALL THE POWER SUPPLY UNIT INSIDE THE TURNSTILE HOUSING AS IT MAY RESULT IN ELECTRIC SHOCK TO PERSONS.

INSTALL THE TURNSTILE OUTSIDE DRY AND HEATED ROOMS.

PREVENT OR ACCELERATE MOVEMENT OF THE TURNSTILE ARMS.

APPLY PASTES AND LIQUIDS CHEMICALLY AGGRESSIVE TO MATERIALS OF THE HOUSING WHEN CLEANING THE PRODUCT.

2.2 Preparing the product for use

2.2.1 Safety measures during product preparation



ATTENTION: TO AVOID INJURIES AND BLOCKING OF THE TURNSTILE, BEFORE CONNECTING THE TURNSTILE, CLEAR THE ARM ROTATION AREA FROM PEOPLE AND FOREIGN OBJECTS.

2.2.2 Rules and procedures for visual inspection of the product

Visual inspection of the product before connecting it to the mains shall be obligatory and include:

- 1) check for product housing mechanical damage: cracks, through holes resulted from fasteners drop-out;
- 2) thorough inspection of all connections of the product.

2.2.3 Turning the product on.

The turnstile comes to the customer folded (transportation mode).

To start working, it must be put into operating position: pull back the arm fixing stopper (Figure 7), holding one arm by hand in a fixed position, unfold the rest of the arms into the operating position.

Connect the PSU to ~220V mains and turn it on. The red indicator on the front indication band of the turnstile will light up.

The side indication bands will be highlighted in red. In this case, the passage will be closed, the LED indicator of the button (Figure 5 – 2) on the control panel will light up in red.

One of the arms will be in a barrier state, which prohibits passage.

The turnstile is ready for operation.

2.2.4 Visual inspection and verification of the product readiness for use:

Figure 3 – possible free travel of the arm, it makes 6 degrees on each side in STOP mode.

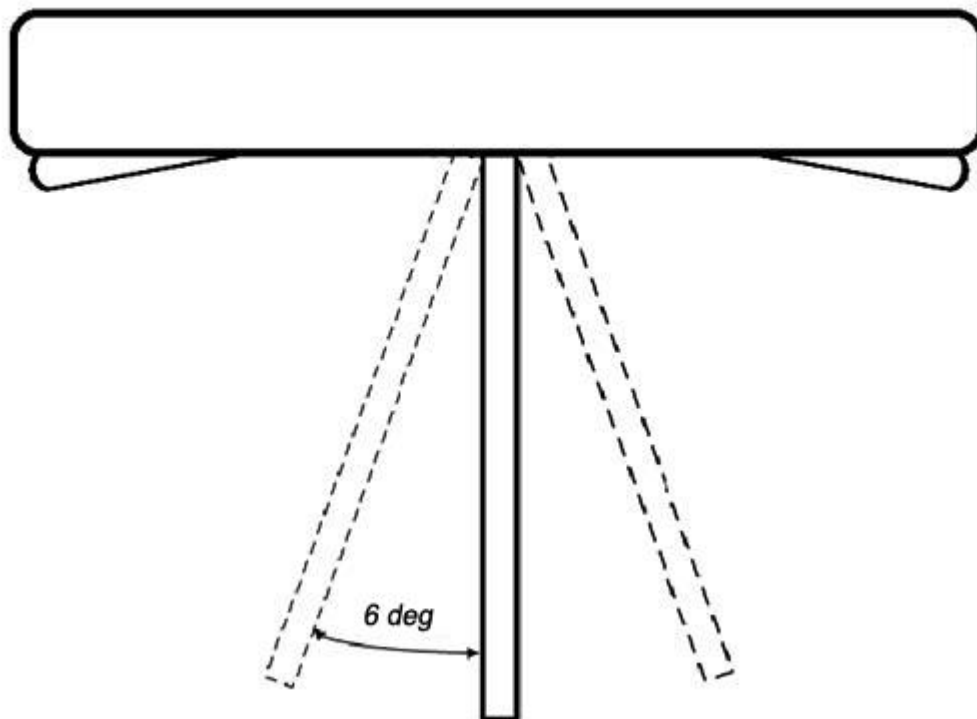
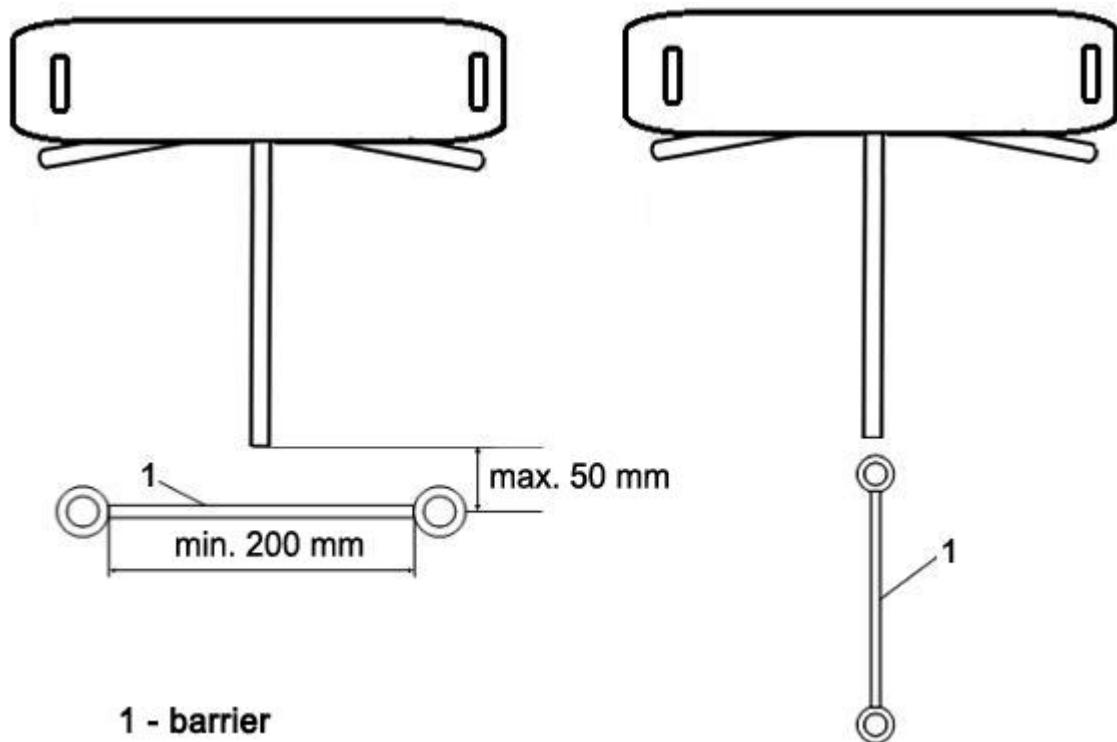

Figure 3 – Possible free travel of the arm in STOP mode

2.2.5 Instructions on product orientation.



ATTENTION: THE PASSAGE ZONES SHALL BE ARRANGED TO ALLOW RECORDING OF PASSAGES DURING TURNSTILE OPERATION UNDER ACS CONTROL AND TO AVOID UNAUTHORIZED PASSAGES.



Recommended scheme

Not recommended scheme

Figure 4 – Turnstile passage zone arrangement.

2.2.6 Control panel settings

Figure 5 – CP appearance. The product can be installed in different ways relative to the user. In some cases, it is necessary to swap left/right passage buttons. This can be done using the following procedure:

- 1) Turn the product power on;
- 2) Press and hold **LEFT** (1) and **RIGHT** (3) buttons until the LEDs on **LEFT** (1) and **RIGHT** (3) buttons blink.
- 3) Press and release **STOP** button (2).
- 4) Press and release **LEFT** button (1).

Now when **LEFT** button is pressed, it will be allowed to pass to the right and vice versa. Current button assignment is stored and not reset when the power

is turned off. To return to the initial setting, repeat the above sequence of operations.

Figure 5 – control buttons 1 (LEFT), 2 (STOP), 3 (RIGHT), 4 (ANTIPANIC) and LED indicators of the product operating modes.

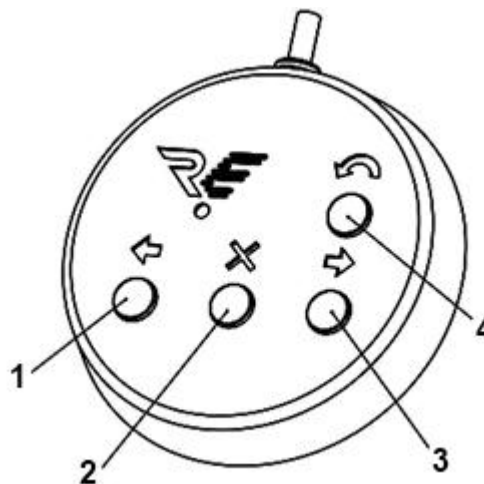

1 - LEFT; 2 - STOP; 3- RIGHT; 4 - ANTIPANIC

Figure 5 – Control panel appearance

2.3 Product operation

2.3.1 Product operating modes

The product can operate in several modes. Desired mode can be enabled using the CP or ACS. The indication of the operating modes is displayed on the band in the form of mnemonic signs depicting authorization and non-authorization of passage. The product operation on the ACS basis is described in the IM.

2.3.2 Controlling the product using the control panel

Figure 5 – over each CP button, there is a LED indicator that displays the turnstile operating mode.

STOP mode

The STOP mode is set when the product is turned on. For switching to the STOP mode from any other mode, press button 2; the LED indicator over button 2 will light up in red. In this case, the front and side indication bands light up in red. The passage in either direction is prohibited in this mode.

The central arm can be deflected from its initial position on a small angle of 6 grades. When the arm is deflected, the stopper will not let it rotate for passage in any direction.

One-time passage mode

Button 1 (3) enables one-time passage mode to the left (right). When this mode is enabled, one pass to the left (right) will be allowed, followed by entering the STOP mode.

In this case, the side indication band will light up in green, indicating a free passage to the left (right). On the front indication band, a group of red lights runs towards the permitted passage.

The color of a group of running lights can be changed using the BUT 1 pass button on the indication control board. The group color can be red, blue or white. To select a color, press the BUT 1 button and hold it until the front surface lights up with the desired color, then release the button.

On the CP, the LED indicator lights up in green over the permitted passage direction button and red over button 2. If a pass has not been completed within 5 seconds, the product automatically enters the STOP mode.

Multiple passage in one direction mode

To enter this mode, press and hold button 2, then press button 1 (3). Both buttons can be released thereafter.

Multiple pass mode is displayed on the control panel by green indicator above button 1 (3), the red LED indicator above button 2 is off.

The side indication band lights up in green, indicating a free passage to the left (right), on the front indication band a group of red lights runs towards the permitted passage.

The passage is allowed in the authorized direction for an unlimited number of times in this mode.

It is also possible to authorize a single pass into the non-authorized direction by pressing button 1 (3). The product will return to the original mode after this passage or within 5 seconds.

Free passage mode

To enter this mode, press and hold button 1, then press button 3 and release both buttons. In this mode, passes in both directions are allowed for an unlimited number of times.

The side indication bands are lighted up in green, indicating free passage to the left and right, and the front indication band is light up in green.

On the CP, the LED indicators over buttons 1 and 3 light up in green.

Antipanic mode

Switching to this mode is carried out mechanically.

Switch the turnstile to Antipanic mode, to do this press button 4 on the control panel.

Pull off the arm fixing stopper (Figure 6 – 1), holding one arm by hand in a fixed position, rotate the other arm clockwise in such a way that all the arms are aligned (Figure 7 –).

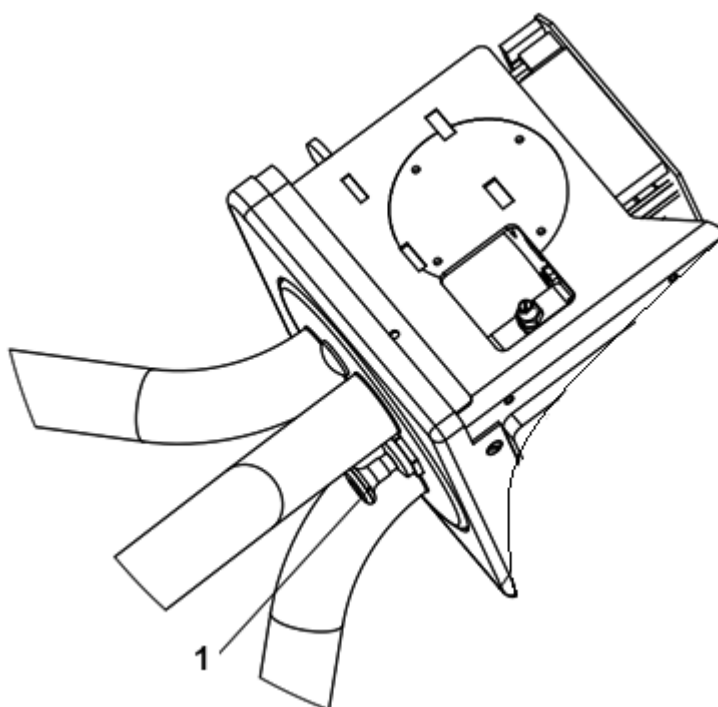

1 - arm fixing stopper

Figure 6 – Arm fixing stopper

Figure 7 – then turn all the arms folded together down.

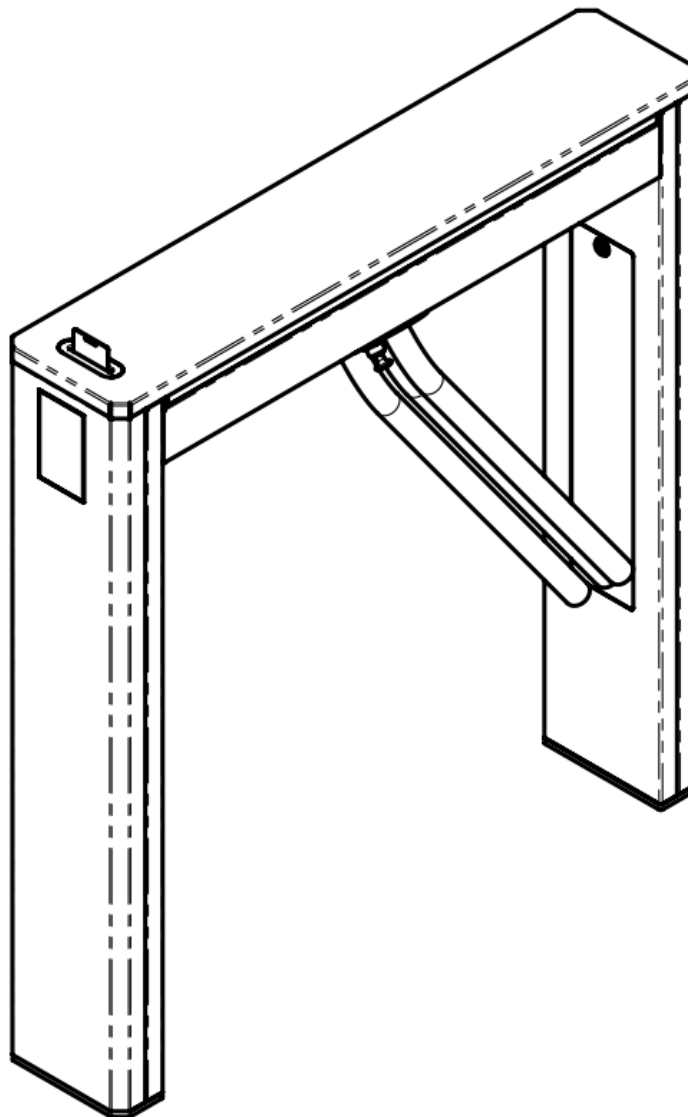

Figure 7 – Turnstile with folded arms

The side indication bands are lighted up in green, indicating free passage to the left (right), and the front indication band blinks in green.

2.3.3 Controlling the product using card collector

When the power is turned on, the standby mode is set. Entering another mode is performed upon provision of a contactless access card.

Passing with permanent user card

Upon presentation of an allowed permanent visitor card (it suffices to lay the card onto the reader), the card collector unlocks the turnstile for the time set by ACS controller (depending on the operating mode; 5 seconds – in pulse mode). No other cards will be accepted during this time period.

If the pass has been completed or after the specified time interval has expired, the card collector goes to standby mode and can accept the next card.

In this case, the side indication band will light up in green, indicating a free passage to the left (right). On the front indication band, a group of red lights runs towards the permitted passage.

Passing with guest card

Guest card should be inserted all the way into the slot, otherwise it will be ignored. If an allowed card is presented, the card collector withdraws it, and unlocks the turnstile for 5 seconds.

Emergency mode

During card collector operation, various unforeseen situations may occur in which a card or a foreign object is clamped by the card collector's shutter. To eliminate such situations, emergency mode is used.

To do this, it is necessary to remove the product top cover and gain access to the card collector board.

Figure 8 – open with a key and remove both containers located inside the turnstile stands.

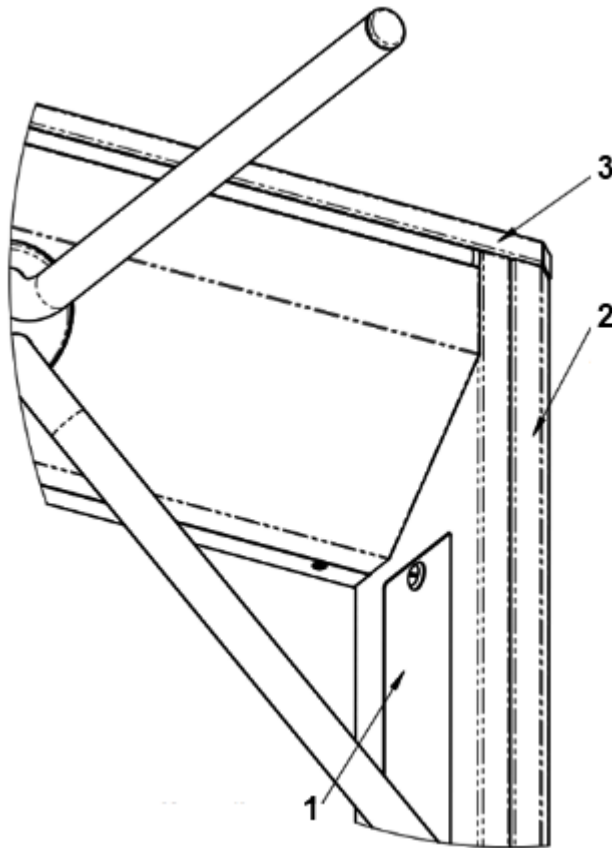

**1 - card collector container;
2 - side cover; 3 - top cover**

Figure 8 – Card collector container

Figure 9 – release the 4 studs securing the top cover and remove the cover in the indicated direction.

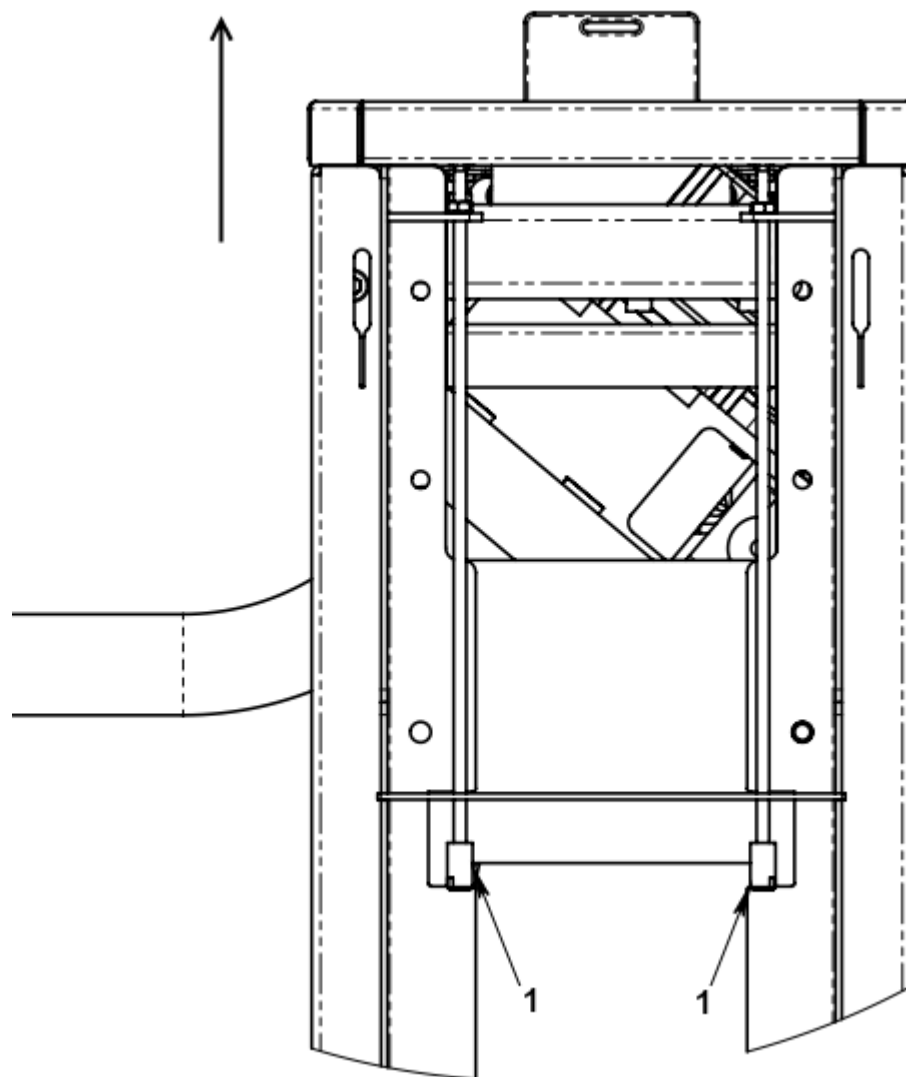

1 – cover fastening studs

Figure 9 – Dismantling of the top cover

Figure 10 – press and hold BUT1 button on the card collector board. When the button is pressed, the card collector shutter is forced open and a continuous beep sounds.

Remove an object, which interferes with normal operation of the system.

Figure 10 – release the BUT1 button.

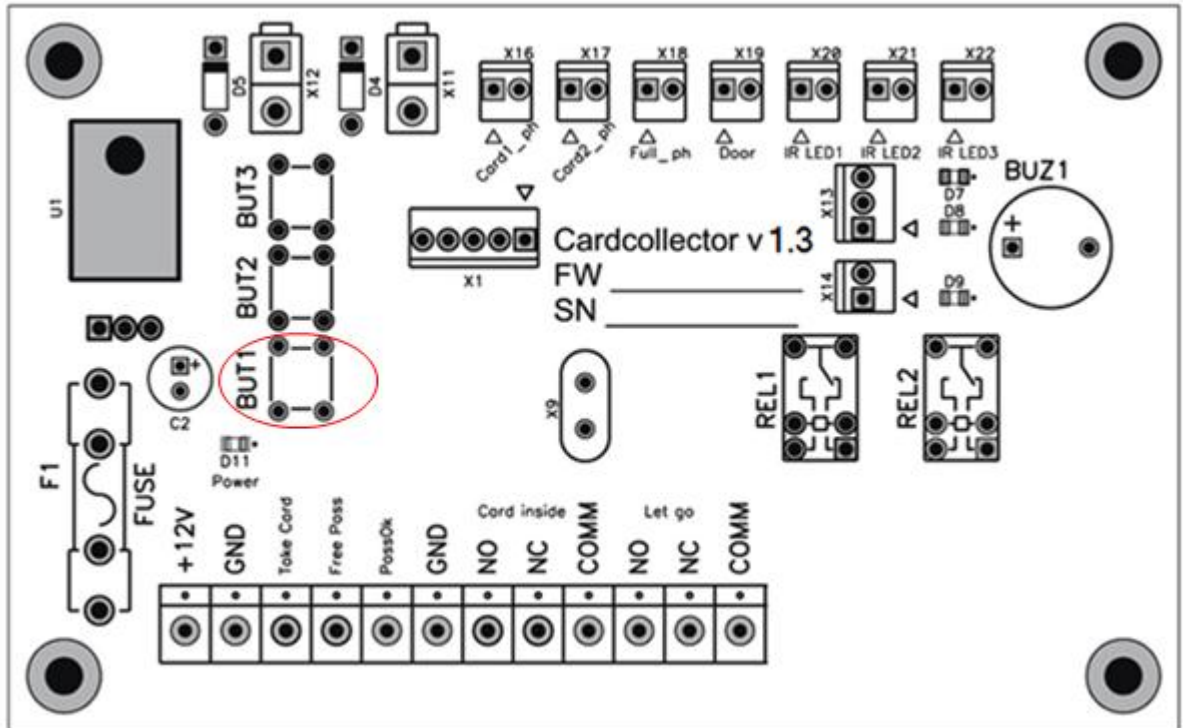

Figure 10 – Appearance of the card collector board

Return the top cover and containers to their original place.

2.3.4 Removing guest cards from the card collector container

Figure 8 – open the container lock with a key. Remove the container and collect the guest cards.

Return the container to its original place.

2.4 Emergency procedures

To open the passageway in an emergency situation, use the ANTIPANIC mode: fold the product arms and clear the passageway in this mode.



ATTENTION: WHEN OPERATING THE PRODUCT, NOTE THAT ELECTRIC CIRCUIT CAN BE A SOURCE OF FIRE DANGER IN CASE OF SHORT CIRCUIT, INSULATION BREAKDOWN AND SPARKING.

In case of fire, switch external power supply off. Use powder extinguishers to extinguish fire in the product, wiring and cables.

3 MAINTENANCE

3.1 General instructions

Maintenance (hereinafter referred to as MNT) of the product shall be carried out in accordance with this Operation Manual.

3.1.1 To maintain product performance and ensure design service life, periodical in-service product MNT shall be performed, including during warranty period.

3.1.2 Scheduled maintenance shall be performed once every 12 months. If a fault occurs, maintenance should be performed immediately after troubleshooting.

3.1.3 Maintenance is recommended to be performed by two persons who are qualified mechanical and electromechanical specialists (or electricians), at least category 3, and who have read and understood this Operation Manual.

3.2 Safety precautions

When performing maintenance, safety measures shall be observed. Maintenance shall be performed by specially trained technical personnel.

**DO NOT:**

PERFORM WORK WHEN THE TURNSTILE POWER IS ON. FAILURE TO COMPLY WITH THESE SAFETY REQUIREMENTS CAN RESULT IN DEATH AND DAMAGE TO HEALTH, COMPLETE OR PARTIAL LOSS OF PERFORMANCE OF THE PRODUCT AND/OR AUXILIARY EQUIPMENT.

REMOVE THE MOTHERBOARD LOCATED UNDER THE INDICATION BAND FROM ITS MOUNTS. OTHERWISE, THE MANUFACTURER'S WARRANTY WILL BE VOID.

REMOVE THE DISC INSTALLED ON THE ARM ROTATION AXIS WITH THE **“DO NOT OPEN”** LABEL TO PREVENT INJURY.



ATTENTION: IT IS NOT RECOMMENDED TO ADJUST THE STROKE LIMITERS OF THE SOLENOIDS OR TENSION OF THE SPRINGS. THESE ASSEMBLIES ARE FACTORY-ADJUSTED. FAILURE TO COMPLY WITH THESE ADJUSTMENTS MAY CAUSE MALFUNCTION OF THE ENTIRE ELECTROMECHANICAL SYSTEM.

3.3 Product maintenance procedure

Maintenance includes the following scope of work:

- 1) visual inspection of the product condition;
- 2) partial disassembly of the turnstile, cleaning of the supporting frame;
- 3) checking fastening parts and assemblies of the turnstile;
- 4) installing dismantled parts to their place;
- 5) general check of the turnstile operation.

3.4 Visual inspection of the product

3.4.1 Visually inspect the product. There should be no visible damage on the product.

3.5 Partial disassembly of the product

To get access to all necessary assemblies of the turnstile, the latter should be partially disassembled.

Figure 11 – this scope of work includes dismantling the card collector containers (1), the top (3) and side covers (2), the barrier arm assembly (4) of the turnstile.

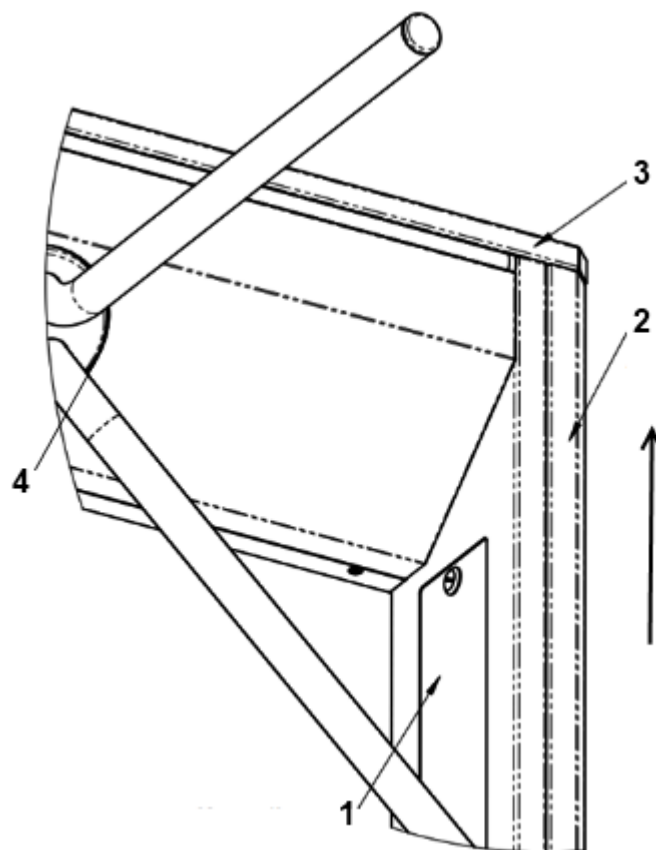

1 - card collector container;
2 - side cover; 3 - top cover;
4 - barrier arm assembly

Figure 11 – Main panels of the product

3.5.1 Turn off the turnstile power supply and disconnect it from power mains.

3.5.2 Dismantling the card collector containers.

Open with a key both containers located inside the turnstile stands.

3.5.3 Remove the turnstile top cover.

2Figure 9 – to remove the top cover, unscrew the 4 studs. Then remove the cover in the indicated direction.

3.5.4 Remove the turnstile side covers.

Figure 11 – using some force, slide the side covers in the indicated direction until they are completely free.

3.6 Checking the product assemblies

3.6.1 Clean the supporting frame from contamination.

3.6.2 Check that all cables are securely attached.

3.6.3 Check and, if necessary, tighten threaded connections of the fasteners of the turnstile assemblies.

3.7 Product assembly and health check

To assemble the product, perform disassembly operation in reverse order:

- 1) install the side covers;
- 2) install the top cover;
- 3) install the card collector containers;
- 4) turn the turnstile power on;
- 5) perform a health check by carrying out several test passes.

If extraneous noise and any violations of operating modes are absent, the turnstile is ready for operation.

If any defects in the product assemblies are found during the product MNT, we recommend to contact service department for advice.

List of addresses of official distributors and service centers is given in Appendix A and is also available at the website: www.oxgard.ru



If it is necessary to repair damaged painted surfaces, use powder paint identical to the damaged one (RAL9005) in accordance with the paint instructions for application.

4 ROUTINE REPAIRS

4.1 Routine repairs of the product

No routine repairs are provided for the product. If faults listed in Table 6 occur, take the following actions.

Table 6 – Typical product malfunctions

| Malfunction | Action |
|---|--|
| PSU is connected, but the turnstile does not work | 1) Check if the power wires are connected correctly; 2) Check the fuse on the cross-board. |
| The CP doesn't work | 1) Check if the control panel is connected correctly; 2) If +24 and GND terminals are connected correctly, try to swap the CL and CH terminals. 3) Check the frequency to which the remote control is tuned. |

If any other problems occur, contact service department.

4.2 Routine repairs of the product components

Routine repairs of the product components shall be carried out by replacing faulty parts with known good ones.

When such replacement is impractical or there are no known good components available for the product, a proprietary repair method shall be used.

4.3 Malfunctions during warranty period

When malfunction occurs during warranty period (Logbook VZR.235900.000 LB), please send a claim to the manufacturer.

To do this:

- 1) prepare a technically substantiated Claim Report;
- 2) make extracts from the LB section “Repair”.
- 3) make extracts from the LB section “Preservation”.

5 STORAGE

The product shall be stored in dry (without moisture condensation) heated rooms at a temperature from +1 to + 40°C. The storage room should be free of acid or alkali vapors, as well as corrosive gases.

The short time product storage in original package shall be permitted for maximum 3 days in dry unheated rooms and enclosed transport bodies.

After storage in unheated rooms, prior to commissioning, the product shall be kept in a room with normal climatic conditions for 12 hours.

6 TRANSPORTATION

The product in the original package can be transported without range limitation by air, enclosed road and rail transport provided it is protected against direct exposure to precipitation and dust.

When transporting and storing products on Euro pallets, it is allowed to stack boxes in 2 rows.

Loading and unloading operations should be carried out in compliance with safety regulations.

7 DISPOSAL

Upon expiry of its service life, the product shall be disposed along with its components.

Examples of such disposal can be product disassembly (dismantling) and sorting its components into groups of similar parts, converting the product into a learning aid or using for purposes other than intended use.

APPENDIX A — DISTRIBUTORS AND SERVICE CENTERS

Lists of official distributors and service centers are given in Tables 7-8 and are constantly updated. The latest information is available at the website www.oxgard.ru.

Table 7 – Distributors and service centers in Russia

| Item No. | Company | Contact details | Status |
|----------|---------------------|---|--------------------------------------|
| 1 | Elics Trading House | 107023, Moscow, M. Semyonovskaya st., 3 (Elektrozavodskaya metro station) 7 (495) 725–66–80 www.elics.ru , elics@elics.ru | Distributor Service center Warehouse |
| 2 | Luis + LLC | 125040, Moscow, Center, 1st Yamskogo Polya st., 28 7 (495) 637–63–17, 7 (495) 280–77–50 www.luis.ru luis@luis.ru | Distributor Warehouse |
| 3 | Luis + LLC | 192029, St. Petersburg, Obukhovskoy Oborony Ave., 70, bld. 3A 7 (812) 331–40–41; www.luis.ru luis-spb@luis-spb.ru | Distributor Warehouse |
| 4 | Luis + LLC | 400081, Volgograd, Bureyskaya st., 7 7 (8442) 43–97–98 www.luis.ru info@luis-don.ru | Distributor Warehouse |
| 5 | Luis + LLC | 620100, Yekaterinburg, Sibirsky Trakt st., 12, bld. 6 7 (343) 298–20–28 www.luis.ru info@luis-ural.ru | Distributor Warehouse |
| 6 | Luis + LLC | 350051, Krasnodar, Dalnyaya st., 2 7 (861) 273–99–03 www.luis.ru info@luis-don.ru | Distributor Warehouse |
| 7 | Luis + LLC | Republic of Tatarstan, 420059, Kazan, Orenburg Tract, 128, bld. 1 7 (843) 204–22–33 www.luis.ru luis@luis.ru | Distributor Warehouse |
| 8 | Luis + LLC | 603086, Nizhny Novgorod, Manufakturnaya st., 14, room 1 7 (831) 214 –71–17 www.luis.ru luis@luis.ru | Distributor Warehouse |

| Item No. | Company | Contact details | Status |
|----------|----------------------------|--|-----------------------|
| 9 | Luis + LLC | 630007, Novosibirsk, Fabrichnaya st., 10 7 (383) 285-33-77 www.luis.ru luis@luis.ru | Distributor Warehouse |
| 10 | Luis + LLC | 614064, Perm, Chkalov st., 7a 7 (342) 206-07-47 www.luis.ru luis@luis.ru | Distributor Warehouse |
| 11 | Luis + LLC | 344029, Rostov-on-Don, Menzhinsky st., 4A 7 (863) 261-82-10 www.luis.ru info@luis-don.ru | Distributor Warehouse |
| 12 | Luis + LLC | 443028, Samara, 18 km of Moscow Highway 7 (846) 203-04-24 www.luis.ru samara@luis.ru | Distributor Warehouse |
| 13 | Luis + LLC | 625048, Tyumen, Ervye st., 9 7 (3452) 48-95-20 7 (3452) 48-95-40 7 (3452) 48-95-35 www.luis.ru samara@luis.ru | Distributor Warehouse |
| 14 | Luis + LLC | 454090, Chelyabinsk, Lenin Ave., 35 7 (351) 220-00-72 www.luis.ru luis@luis.ru | Distributor Warehouse |
| 15 | Layta Trading House | 410056, Saratov, Ulyanov st., 17A 7 (8452) 392-057, 7 (8452) 735-575 7 (8452) 524-586 www.layta.ru info@layta.ru | Dealer |
| 16 | Layta Trading House | 355000, Stavropol, Pirogov st., 20A 7 (8652) 550-111 7 (8652) 551-529 7 (8652) 552-311 7 (8652) 552-411 7 (8652) 553-211 www.layta.ru info@layta.ru | Dealer |
| 17 | Bezopasnost | Moscow, 12th Parkovaya st., 5 7 (495) 150-10-71 (multi-line) sales@podkontrolem.ru www.podkontrolem.ru | Dealer Service center |
| 18 | Pocketkey | 123290, Moscow, Prichalny Driveway, 8, building 1, room 502 7 (495) 107-09-10 hello@pocketkey.ru www.pocketkey.ru | Dealer |
| 19 | Ravelin LTD. | Professor Popov st., 4 7 (812) 327-50-32 ravelin@ravelinspb.ru , www.ravelinspb.ru | Dealer Service center |
| 20 | Corporate Business Systems | 123181, Moscow, Isakovskiy st., 33, bld. 3 7 (495) 234-68-51 www.cbs-group.ru sales@cbs-group.ru | Dealer Service center |

| Item No. | Company | Contact details | Status |
|----------|--|---|--------------------------|
| 21 | Corporate Business Systems | 344002, Rostov-on-Don, Solyanoy Spusk Lane, 8-10, 34 7 (495) 234-68-52 www.cbs-group.ru sales@cbs-group.ru | Dealer Service center |
| 22 | Inforser (Unified System Technologies) Group | 109428, Moscow, Ryazansky Ave., 24, bld. 2 7 (495) 660 17 33 www.inforser.ru | Dealer Service center |
| 23 | Benar | Khabarovsk, Neftyanaya st., 14 8 962 587 11 69 бенар.рф sales@khab-tech.ru | Dealer Service center |
| 24 | ATM | St. Petersburg, Revolyutsii Highway, 31 7 (812) 640-85-84 7 (812) 655-62-05 www.atmcompany.ru info@atmcompany.ru | Dealer |
| 25 | Center for Security Systems CJSC | 195197, St Petersburg, Polyustrovsky Ave., 32, Letter K, office 201 7 (812) 240-31-00 market@cesb.ru ,http://www.cesb.ru/ | Dealer |
| 26 | SMNP-3 LLC | Magadan, Gorkogo st., 8 7 (41322) 307 47 fuks@smnp-3.ru | Dealer Service center |
| 27 | IT Solutions for Business | 236009, Kaliningrad, Krasnokamennaya st., 42 7 (4012) 33-79-18 7 (4012) 76-79-18 it@it-sb.ru | Dealer |
| 28 | Intellectual Systems | 394006, Voronezh, Chelyuskintsev st., 145 7 (473) 250-20-01 inbox@int-sys.ru | Dealer |
| 29 | Intellectual Systems | 398026, Lipetsk region, Lipetsk, Zhelyabov st., 2, office 307. 7 (4742) 51-58-77 inbox@int-sys.ru | Dealer |
| 30 | Tinko Trading House | 111141, 3rd Perova Poly Driveway, 8 (Perovo Polye Business Center, 3rd floor), Perovo metro station 7 (495) 708-42-13 www.tinko.ru tinko@tinko.ru | Sub-dealer |
| 31 | Satro-Paladin LLC | 129515, Moscow, Kondratyuk st., 9, bld. 1 7 (831) 272-55-75 7 (831) 412-93-11 www.satro-paladin.com dir@nn.satro-paladin.com | Dealer |
| 32 | Satro-Paladin LLC | 603070, Nizhny Novgorod, Meshchersky Ave., 7, bld. 3, office 10 7 (831) 272-55-75 7 (831) 412-93-11 www.satro-paladin.com dir@nn.satro-paladin.com | Dealer |

| Item No. | Company | Contact details | Status |
|----------|--------------------------------|--|---------------------------------------|
| 33 | Satro-Paladin LLC | 400009, Volgograd, Tarifnaya st., 13 7 (8442) 56-49-94 7 (8442)71-08-01 7 (8442)76-56-29 www.satro-paladin.com dir@nn.satro-paladin.com | Dealer |
| 34 | Videoglaz Center LLC | 105187, Moscow, Volnaya st., 35, bld. 19 7-(495)-280-71-70 www.videoglaz.ru zakaz@videoglaz.ru | Dealer |
| 35 | Videoglaz | St. Petersburg, Ligovsky Ave., 266V, 3rd floor 7 (812) 245-28-24 www.videoglaz.ru zakaz@videoglaz.ru | Dealer |
| 36 | Birzha LLC | 109052, Moscow, Nizhegorodskaya st., 29-33, bld. 32, office 402 7 (495) 229-45-15 www.global-id.ru info@global-id.ru | Dealer |
| 37 | STELS LLC | Amur region, Blagoveshchensk, Artileriyevskaya st., 17 7 (4162) 777-888 7 (4162) 525-777 7 (4162) 519-777 www.global-id.ru ctb@stels-amur.ru sale@stels-amur.ru | Dealer Service center Warehouse |
| 37 | Complex Security Systems Group | Vladikavkaz, Kolka Kesaev st., 3 7 (8672) 40-35-4 7 (8672) 40-58-94 www.ksb-rso.ru ksb-rso@mail.ru | Dealer Service center |
| 39 | Profbezopasnost LLC | Sochi, Rose st., 115/1 7 (800) 700-51-90 www.profbez.pro info@profbez.pro sale@profbez.pro | Dealer Service center |
| 40 | APL LLC | St. Petersburg, 9th Sovetskaya st., 4, office 312 7 (812) 401 63 34, 7 921 55 111 01 www.aplspb.ru info@aplspb.ru | Dealer Service center |
| 41 | ALPRO | Address: 194100, St. Petersburg, Bolshoy Sampsonievsky Ave., 70, letter V, room 3N, POLAR Business Center 7 (812) 702-17-52 www.alpro.ru sales@alpro.ru | Dealer |
| 42 | InfoTec LLC | St. Petersburg, Moskovsky Ave., 103/3 7 (812) 327 95 10 7 (812) 327 95 06 www.infotec.ru contact@infotec.ru | Dealer |
| 43 | ForTrade LLC | 196105, St. Petersburg, Lyubotinsky Ave., 5, Letter "B", office 310 8 (812) 309-58-53 www.fteq.ru 4trade@fteq.ru | Dealer |

| Item No. | Company | Contact details | Status |
|----------|-------------------------|--|--------|
| 44 | Grumant Corporation LLC | 630123, Novosibirsk, Krasnogorskaya st., 27a 8 (383) 210-352-353 www.grumant.ru info@grumant.ru | Dealer |
| 45 | Grumant Corporation LLC | 107553, Moscow, 1st Pugachev st., 25, office 118 7 (495) 783-29-60 7 (499) 161-06-91. www.grumant.ru mf@grumant.ru | Dealer |
| 46 | Grumant Corporation LLC | 299038, Crimea, Sevastopol, Kolobov st., 35/4 7 (978) 744 38-86 7 (978) 744-38-59 www.grumant.ru krim1@grumant.ru krim2@grumant.ru | Dealer |
| 47 | Modus Trade LLC | 644046, Omsk, Mayakovsky st., 14 7 (3812) 51-00-93 7 (3812) 51-07-29 | Dealer |

Table 8 – Foreign distributors and service centers

| Item No. | Company | Contact details | Status |
|----------|---------------|--|-----------------------|
| 1 | VZR System OU | Tulika tn 19, Tallinn 372 5844 4957 8 921 996 2746 www.vzrsystem.ee info@vzrsystem.ee | Distributor Warehouse |

| Item No. | Company | Contact details | Status |
|----------|--|--|--------------------------|
| 2 | VZR System OU | Hofer St. 39 95183 Feilitzsch-Zedtwitz Deutschland 372 5844 4957 8 921 996 2746 49 9281 140 11 65 49 928 1 140 11 16 www.multitrans.net ksemjonow@multitrans.net ue@multitrans.net | Distributor Warehouse |
| 3 | TD INTANT, LLP | Republic of Kazakhstan, Almaty, Muratbayev st., 61 7 (727) 225-35-35 7 (727) 220-95-31 www. security.intant.kz intant@intant.net | Dealer Warehouse |
| 4 | A+A Security MMC | AZ1110, Azerbaijan, Baku, Akhmad Bay Aga oglu st. 24B 8 (+994 12) 496-00-56 www.aasecurity.az info@aplusa-security.com | Dealer |
| 5 | Victiana S.R.L. (Videosecurity Moldova) | Republic of Moldova, Chisinau, Hajdeu st., 66/3 373 (22) 876-000 373 (22) 876- 001 www.videosecurity.md info@videosecurity.md | Dealer |
| 6 | Security and Safety Systems Unitary Enterprise | Minsk, Petr Glebka st., 1 375 (17) 390-66-66 (multi-line) Mob.: +375 (33) 340-11-11 (MTS) www.sob.by info@sob.by | Dealer Service center |
| 7 | OÜ Almasel | Mustamäe tee 102-106 Tallinn Harjumaa 12917 Tel +372 59192909 info@almasel.com | Service center |

ABBREVIATIONS

The following abbreviations are used in this document:

LB — Logbook;

OM — Operation Manual;

IM — Installation Manual;

PSU — power supply unit;

CP — control panel;

ACS — access control system;

MNT — maintenance.

Vozrozhdenie LLC
192289, 66, Sofiiskaya str.,
Saint-Petersburg, Russia
Telephone/Fax +7 (812) 366 15 94
www.oxgard.com
info@oxgard.com

